



The Firestone Medical Research Building

at the UVM Larner College of Medicine

Imagine the fall of 2022, as the Larner College of Medicine marks its 200th anniversary. Rising four stories above the south end of the College's Burlington campus, faculty, students, and staff will see the latest chapter in the school's history: the Firestone Medical Research Building.

Team-Oriented Research

The Firestone Medical Research Building brings to UVM 59,000 square feet of versatile space that can adjust with the flow of varied research projects in the coming years.

Ensuring Our Future

To support the continued success of today's Larner researchers, and attract the next generation of outstanding scientists, we need new, enhanced facilities.

The Right Time to Grow

With research success at the Larner College of Medicine at an all-time high, momentum has never been greater, and the need more acute, for expanded, modern facilities.

*Now is the time to support the next century of research progress
at the UVM Larner College of Medicine.*

Firestone Medical Research Building Facts

- 59,000 total square feet
- 225 estimated personnel capacity
- 34 principal investigator offices
- 200 wet benches
- \$44 million total cost
- \$20 million goal for philanthropy

Key Dates

- October 2020: Construction resumed after Covid-19 delay
- May 2021: Steel Framing completed
- Fall 2022: Construction completed
- Winter 2023: Research commences in new building

The Firestone Medical Research Building

at the UVM Larner College of Medicine

Research Programs and Themes Planned for the Facility

- Cardiovascular Health
- Brain Health
- Cancer
- Lung Disease

Pictured: The Anton Courtyard, funded by a generous million-dollar gift from Raymond Anton, M.D.'70



Firestone Medical Research Building Naming Opportunities

- Level 2 Entry Area
- Lab Write-Up Area
- Small Conference Room
- Research Lab Bench Area
- Larger Conference Room and Hallway
- Computational & Collaboration Zone

Click on each image to open a 360° view:

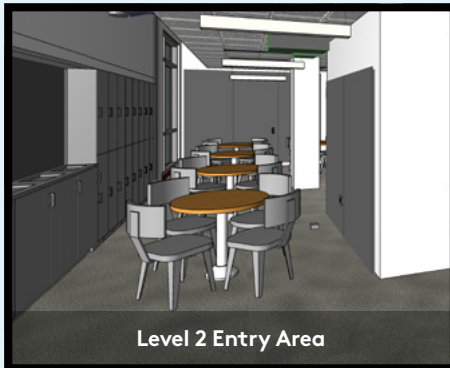

Level 2 Entry Area



Research Lab Bench Area



Lab Write-Up Area



Large Conference Room and Hallway



Small Conference Room



Computational & Collaboration Zone

For more information about supporting the Firestone Medical Research Building contact:
Manon O'Connor, Associate Vice President, Major Gifts
Manon.Oconnor@uvmhealth.org ■ (802) 734-0711



The University of Vermont
LARNER COLLEGE OF MEDICINE