

New Research Building & Space Planning Update & Listening Session

September 2018



The University of Vermont
LARNER COLLEGE OF MEDICINE

Agenda

- New research building design updates
- Space planning and implementation timeline
- Space allocation vision, metrics, & governance planning
- The way forward



New Research Building Design Updates

- Exterior hardscape and saddle slope
- East façade shift from glass storefront & natural light considerations
- Office space above loading dock



Exterior – Hardscape and Saddle Slope



North elevation – lower sills at addition



HSRF East elevation & slope



Exterior – East Façade

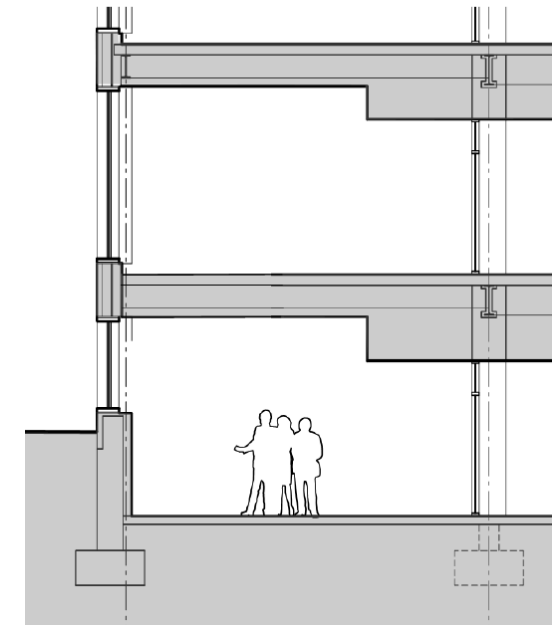
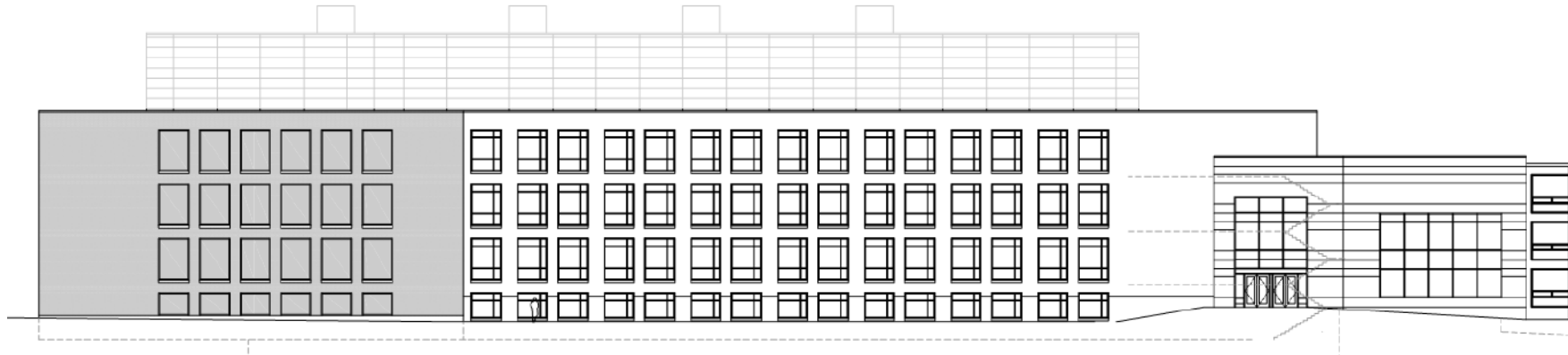
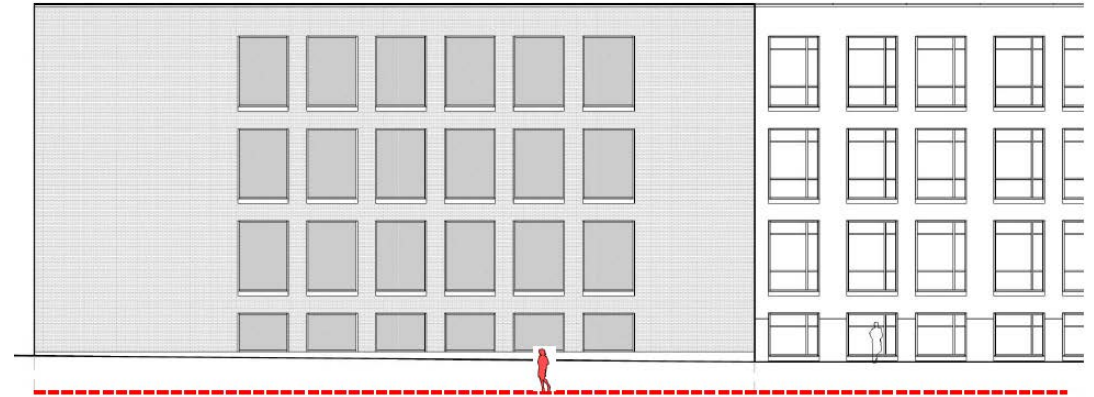

Exterior – East Façade & Natural Light Considerations

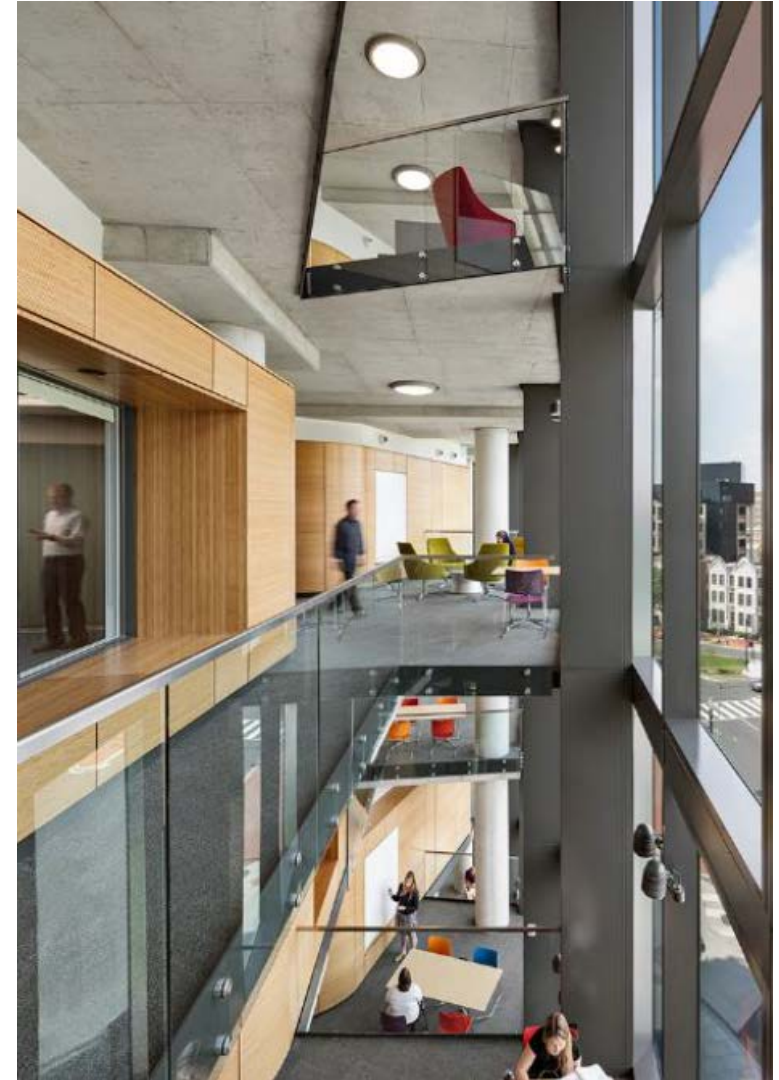
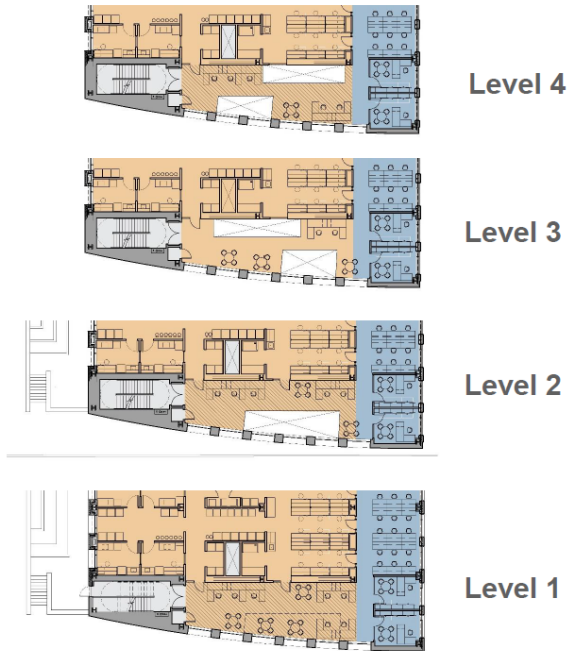
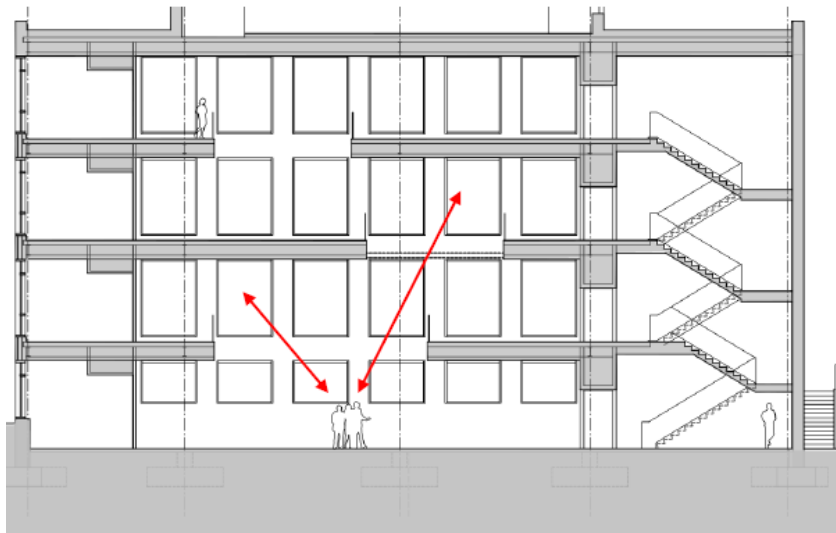
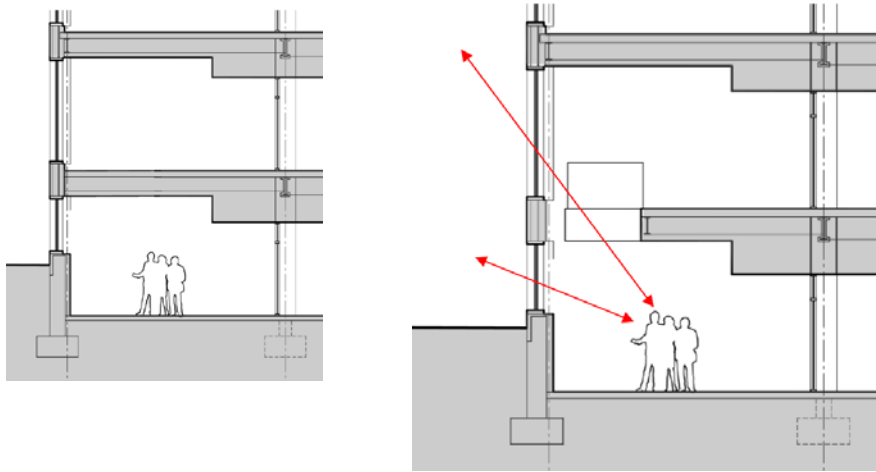

Office Space Above Loading Dock – Floors 3 & 4

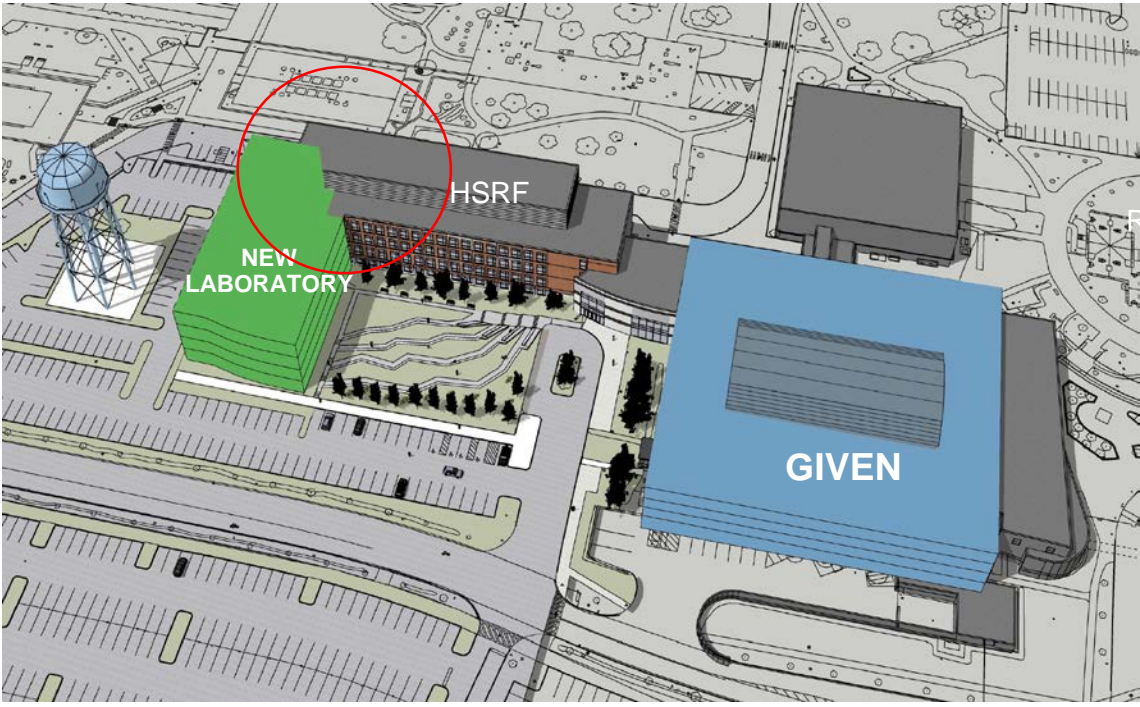

Initial Design

Updated Design

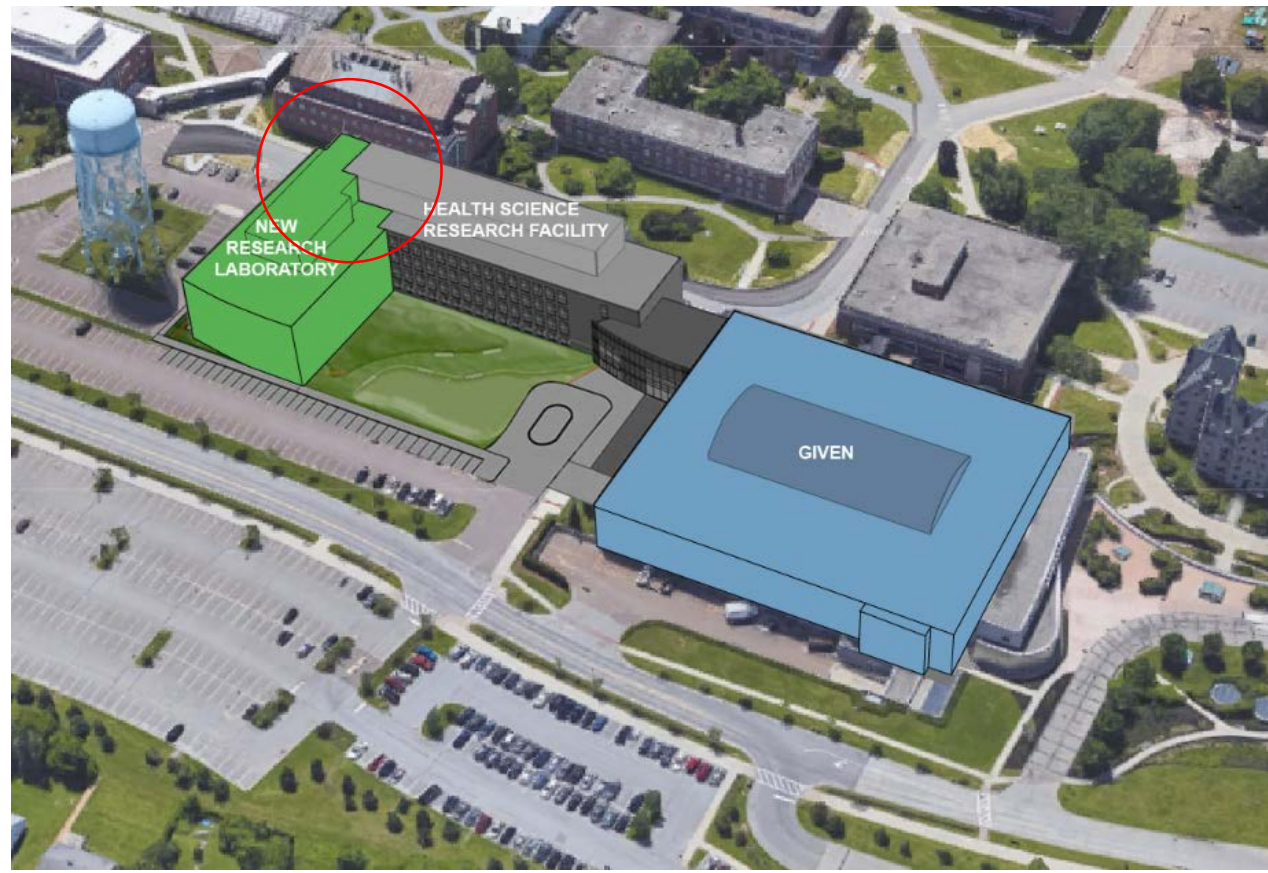

Office Space Above Loading Dock – Floors 3 & 4



South façade (view from Jeffords)



West façade (view from Stafford)



Office Space Above Loading Dock – Floors 3 & 4

1st Floor



2nd Floor



3rd Floor

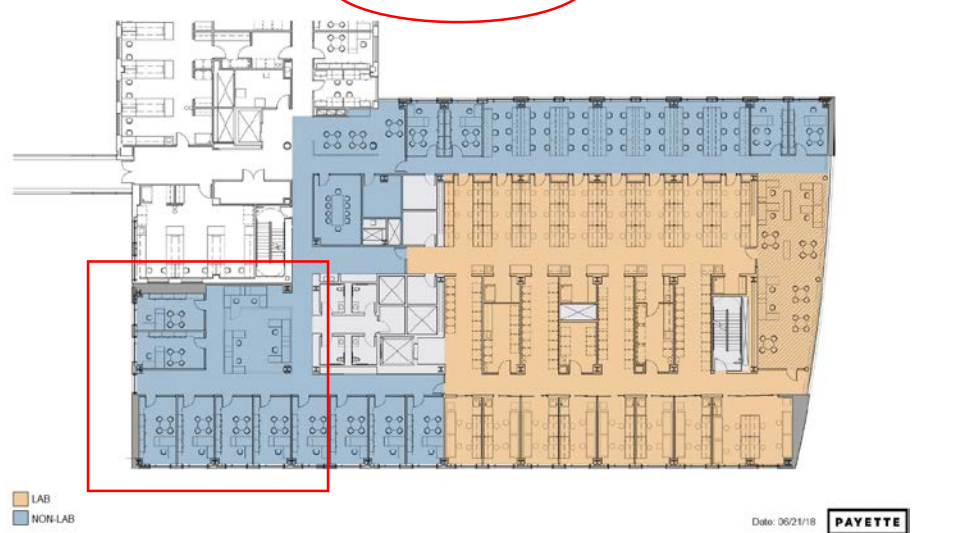

4th Floor



Space Planning & Implementation Timeline

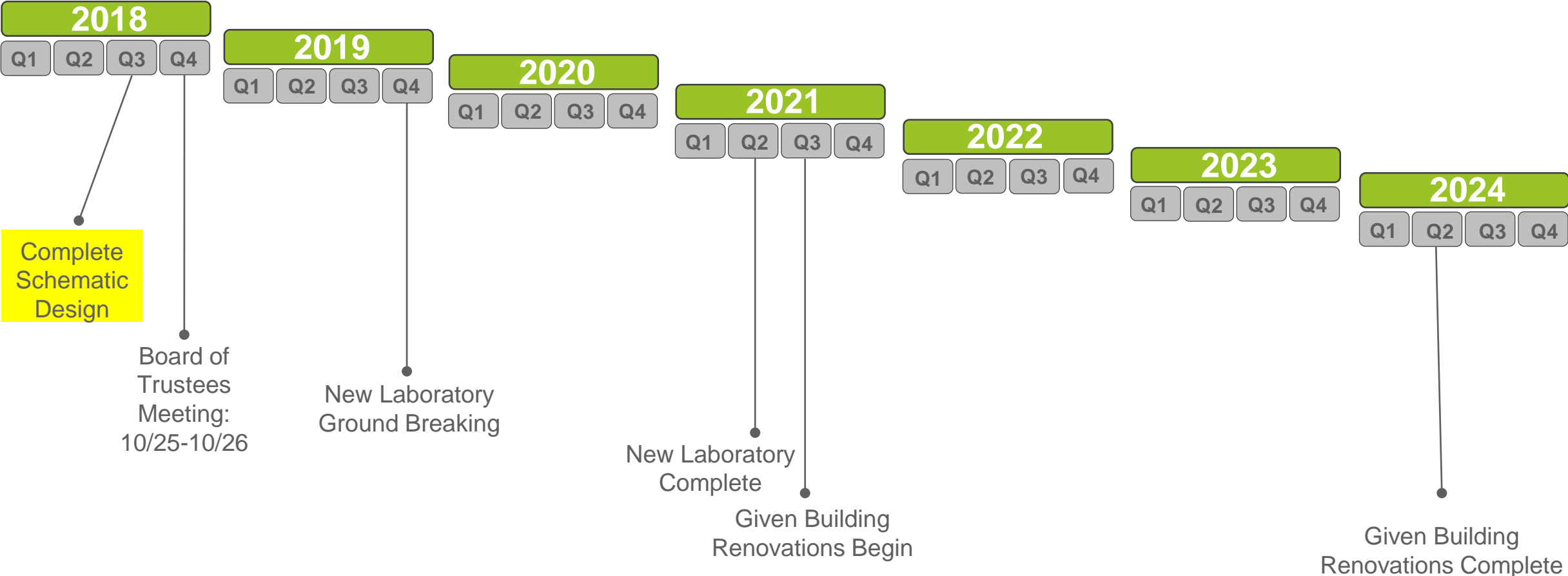

Space Allocation Vision, Metrics, & Governance Planning

Vision: perform strategic facility planning through a holistic space assignment process driven by lab needs and building capabilities to leverage LCOM success

Governance Planning Timeline:

- 2016-2018: Gather Facts - “what is”
- 2019: Options - “what could be”
- 2020: Evaluate Solutions – “minimal amount of moves”
- 2021-2024: Implementation in Phases



Space Allocation Vision, Metrics, & Governance Planning

Planning Factors & Definitions (<i>People and Program First</i>)		
Factor	Definition	Evaluation Criteria
Mechanicals	Building infrastructure to support research needs	Requirement : Capabilities
Productivity	Research team's size, funding, publications, etc.	LCOM faculty productivity metrics
PI Need	Does current location support PI needs? Safety requirements to accommodate? Organism separation considerations?	Unique
Personnel	# personnel involved in lab/program	One area or multiple areas
Geography	Research team's proximity to collaborators and/or home department	Varied
Access	Access to core facility infrastructure	Shorter distance is better

The Way Forward...

Planning Timeline:

- Now through October 2018: assemble data
- Nov. '18-Jan. '19: review data with Chairs & Program Directors for initial feedback
- Feb.-Apr. '19: review data with PIs for initial feedback
- May '19-Apr. '20: space allocation alignment process

Stay Tuned By:

- Viewing the proposed Biomedical Research Complex [website](#)
- Communicating with us and/or New Research Building [Advisory Group](#)
- Attending future Listening Sessions and/or Town Hall Meetings

Comments / Questions?

